

**24513**

**B. Tech 7th Semester Civil F-Scheme Examination,  
December-2017  
ESTIMATING AND COSTING  
Paper-CE-405-F**

*Time allowed : 3 hours ] [ Maximum marks : 100*

*Note : Attempt five questions in all. All questions carry equal marks.*

1. Explain
  - (a) Principle of Estimation
  - (b) Sinking fund
  - (c) Type of estimate
  - (d) Earnest money
  - (e) Tender
  - (f) Actual cost
  - (g) Difference between scrap and salvage value
  - (h) Revised and supplementary estimate. 20

**Section-A**

2. What do you mean by estimate ? Also explain the different method of estimate in detail. 20
3. Find the quantity of earthwork, lime concrete in foundation and brickwork in super structure of Single

24513-P-3-Q-9 (17)

[P.T.O.]

(2)

24513

room with verandah as per plan and elevation given below. And door size 1.2 m × 2.0m

20

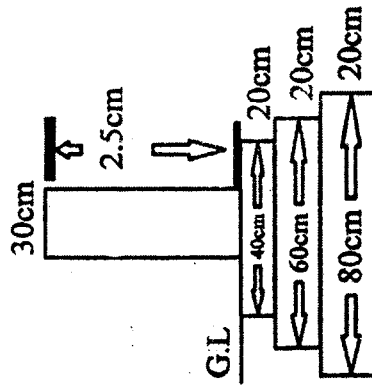
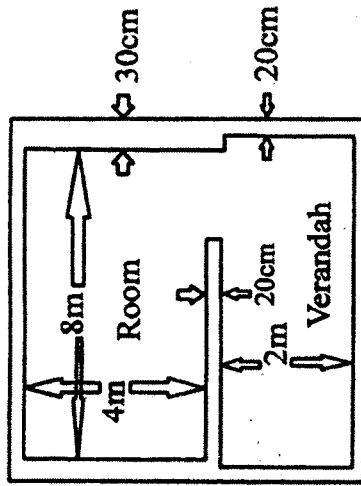

Section-B

4. Write the specification for the following item

- (a) Plaster
- (b) RCC

20

(3)

24513

5. Explain the specification for different class of building.

20

Section-C

6. Find the rate analysis for 100 cu.m brickwork with mortar of ratio 1:6. 20

7. What is rate analysis? Also explain its importance in construction work. Find the rate analysis for 100sq m of white washing. 20

Section-D

8. (a) Explain the need of muster roll. Also explain the rule to prepare muster roll. 20

(b) What is procedure to maintain measurement book?

9. (a) What is depreciation? Explain different method of depreciation. 20

(b) What do you mean by Tender and its acceptance? 20